

Teaching with Bitmoji: Where Pop Culture Meets Education

Cyndi Kuhn

KNEA Feb. 17, 2021

To view the videos and other resources in this presentation go to:

<https://wke.lt/w/s/5aCcoj>



Bitmoji



Why Use Bitmoji?

- Foster personal connections
- Shows we can be relatable
- Playful, silly, yet appropriate
- Make students feel special with personalized messages!



WHY?



Create & Build a Bitmoji

How To Edit a Bitmoji

- 1) Log into your Bitmoji account through the App on a SmartPhone.
- 2) Select "Avatar" button at the bottom and make adjustments.



- 3) Through the Chrome Extension, make sure you sign-in using the same email as the SmartPhone app!

School vs. Personal Bitmoji

You can create one Bitmoji per account through the App. You can create as many accounts as you would like (just all through different email addresses).

Whatever email address you log into through the Chrome Extension, that is the Bitmoji that will sync with your Chrome browser.

Step 1: (App) To create and build a Bitmoji, you need to start with the app. This can be done on a SmartPhone (iPhone or Android) or tablet/iPad.

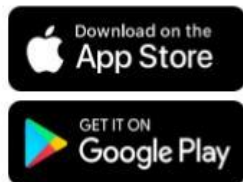

Step 2: (App) After you download the app & open it, you will see this screen. To create a new bitmoji, click "Sign up with Email".

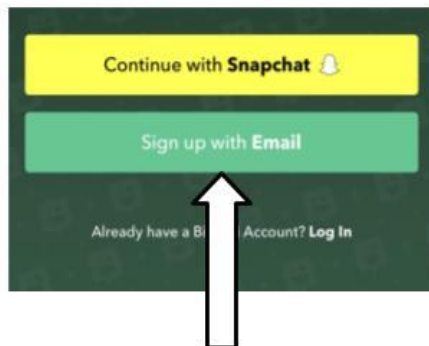

Step 3: (App) Add your birthday.
**This is just to see that you're over the age of 13.*

When were you born?

Select your birthday

Continue		
February	17	1999
March	18	2000
April	19	2001
May	20	2002
June	21	2003
July	22	2004
August	23	2005

Step 4: (App) Type username & password

App Store 10:52 PM 56%

Sign Up

Email Address

Password

By tapping Sign Up, you acknowledge that you have read the [Privacy Policy](#) and agree to the [Terms of Service](#).

Sign Up

Step 5: (App) Start to craft your bitmoji



Step 6: (Computer) Through browser, download the [Chrome Extension](#). Sign-in with the same email that you used through the app.



After you create your account...

Download the Bitmoji Chrome Extension & sign-in with the same account you used on your Smart Device to create your avatar.



Bitmoji

Offered by: bitmoji.com



1,683

| [Social & Communication](#)



1,000,000+ users

Finding Your Bitmoji

→ Chrome Extension

→ Gmail

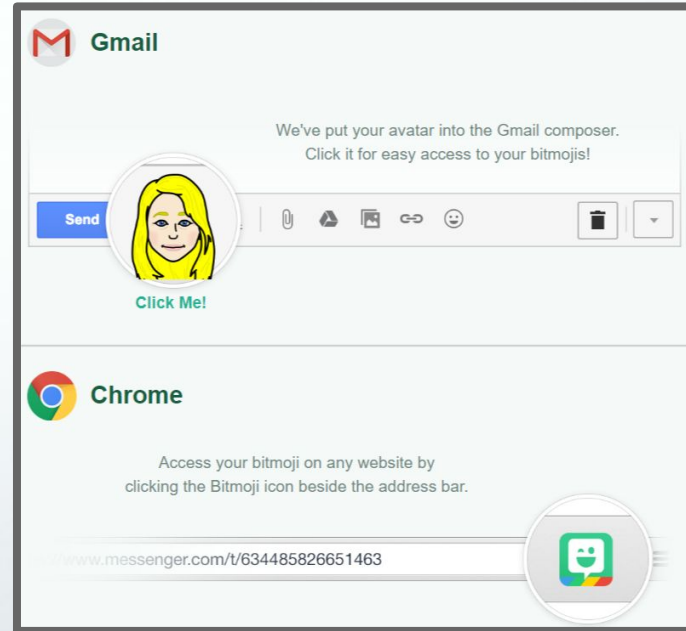

Gmail Signature

Cyndi

cyndidk@ksu.edu

edtechksu@gmail.com (text messaging)

785-320-0025 (text messaging)

Cyndi Kuhn

cyndidk@ksu.edu

College of Education, Kansas State University

[Website](#) [Twitter](#) [Wakelet](#) [Pinterest](#) [Instagram](#)



How to Put a Bitmoji in Your Email Signature



Design a Custom Google Classroom Header

→ Use this [template](#)



Student Feedback

- Add personality to feedback
- Students are more likely to read and react

<https://bit.ly/3rYRanI>

Click image



**Teacher
Tech**

with Alice Keeler

Bitmoji Feedback in My Google Doc

by admin | Sep 18, 2016 | Chrome, Docs, Google, Intermediate | 0 comments

Virtual Classrooms

- Virtual Field Trips
- Scavenger Hunts
- Recreate Your Classroom
- Follow this Facebook group!



For LOTS of info about creating Bitmoji scenes and classrooms. Click [HERE](#)



Welcome to Our Wall of Fame



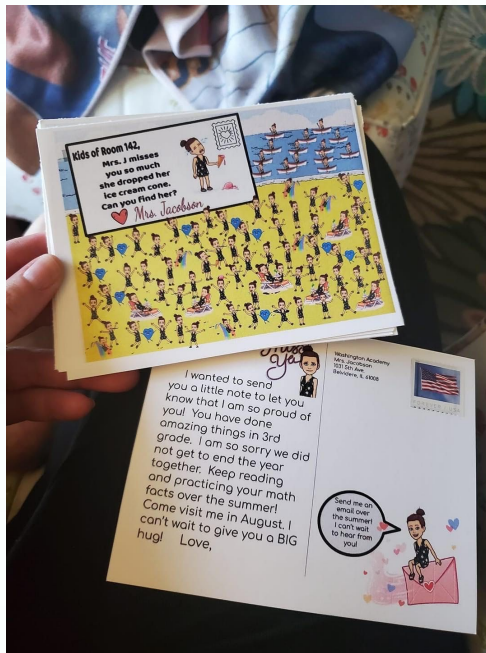

Where's Waldo? Postcard

Click here



[How to Create Your Own](#)

Ways to Use Bitmoji from teachers

- Add to presentations
- Visuals for class rules/procedures
- Instructions
- Enhance newsletters/letters to families
- Motivational posters
- Flat "Bitmoji"

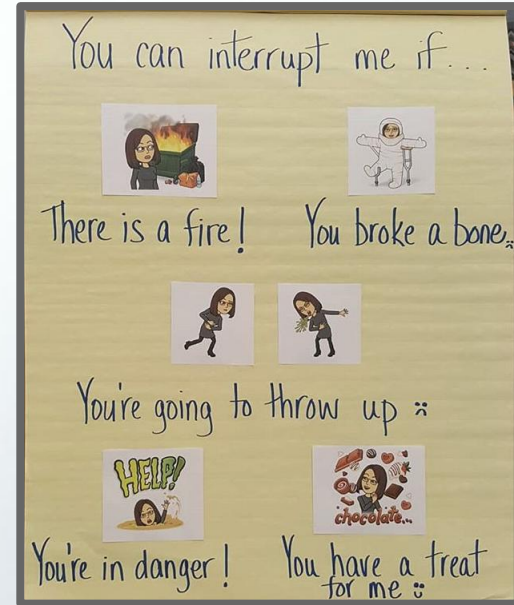

Ways to Use Bitmoji from teachers

- Enhance worksheets
- Digital stickers/feedback
- Bookmarks
- Welcome sign

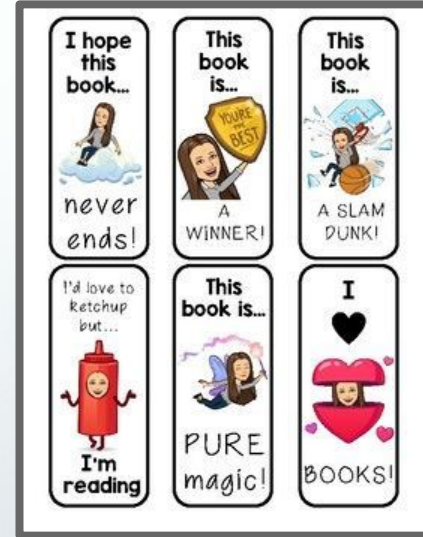
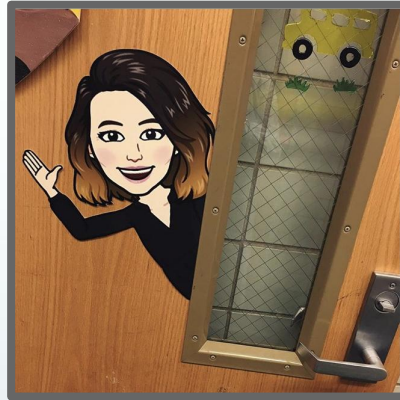
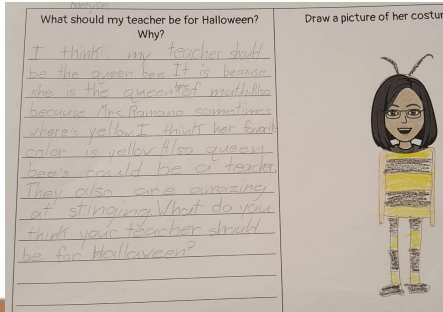

Additional Tips and Resources

All located on the Wakelet

- [Q and A about Bitmoji Classrooms](#)
- Student Friendly Avatar Creation tool - <https://getavataaars.com>
- [How to create a Bitmoji Classroom](#)
- Bitmoji blocked at your school? Save images to Google Drive to use later or or a folder on your computer.
- <https://wke.lt/w/s/5aCcoj>

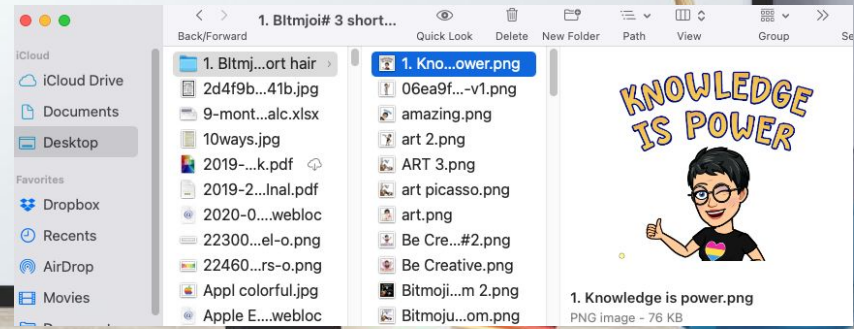

Resources are all located here

<https://wke.lt/w/s/5aCcoj>

